

T500

BIMETAL THERMOMETERS

All stainless steel
Short response time
With or without external zero adjustment

CASE DIAMETER
 100, 125 and 150 mm

ACCURACY CLASS
 1 per EN 13190

TEMPERATURE RANGE
 From -70 to +500 °C

AMBIENT TEMPERATURE
 From -20 to +60 °C

STEM PRESSURE RATING
 25 bar (without thermowell)

STANDARD FEATURES

CASE AND RING
 Material: AISI 304 ss
 Style: bayonet ring
 Protection class: IP 65
 (EN 60529 / IEC 529)

TEMPERATURE ELEMENT
 Coiled bimetal

POINTER
 Black aluminium
 Fixed or adjustable

ZERO ADJUSTMENT
 External on the back of case or through adjustable pointer

WINDOW
 Glass 4 mm thickness

STEM
 AISI 316 ss

STEM DIAMETER
 6 - 6.4 - 8 - 10 - 12 mm for stem lengths over 1 m diameter 8 - 10 - 12 mm only

STEM LENGTHS
 Standard lengths from 90 to 600 mm depending on ranges, over 600 mm on request

CONNECTIONS
 Plain, fixed or adjustable
 Back, lower and every-angle
 Every-angle connection the dial face can be rotated 360° and angled 180°

THREAD SIZES
 ½" BSP or NPT-M standard
 Sliding on stem or fixed

SERVICE TEMPERATURE
 Continuous less than 425 °C
 For continuous service over 425 °C, use inert gas type

OVERRANGE LIMITS
 Up to 120 °C : 100% F.S.
 160 to 300 °C : 50% F.S.
 400 to 500 °C : 510 °C

UNIT OF MEASUREMENT
 Degree Celsius or Fahrenheit

OPTIONAL EXTRAS
 Case & stem filled with:
 glycerine (+15 to +160 °C) (1)
 silicon oil (-45 to +250 °C) (1)
 fluorolube (-40 to +200 °C) (1)
 Case and ring AISI 316 ss
 Other thread sizes
 Dual scale °C / °F
 Safety glass
 Plastic window (not for ATEX version)
 Thermowells (see TW data Sheet) according to user specification.
 ATEX version (2)



Note:
 (1) Temperature ranges
 (2) ATEX version
 II 2 GD c
 Installation with thermowell only

TEMPERATURE RANGES
 Scale, measuring range, limit of error per EN 13190 class I

Scale range °C	Scale spacing °C	Measuring range (1) °C	Error limit °C
-70/+30	1	-60/+20	1
-50/+50	1	-40/+40	1
-30/+50	1	-20/+40	1
-20/+60	1	-10/+50	1
0/60	1	+10/+50	1
0/80	1	+10/+70	1
0/100	1	+10/+90	1
0/120	2	+10/+110	2
0/160	2	+20/+140	2
0/200	2	+20/+180	2
0/250	5	+30/+220	2.5
0/300	5	+30/+270	5
0/400	5	+50/+350	5
0/500	5	+50/+450	5

(1) The measuring range is indicated on dial by two triangular marks. Within this range the stated limit of error is valid according to EN 13190.

STEM LENGTHS TABLE
 Minimum stem length mm

Scale range °C	Stem Ø 6 or 6.4	Stem Ø 8 or 10	Stem Ø 12
0/60	150	135	130
0/80	135	110	105
0/100	115	110	105
0/120	110	100	95
0/160	100	90	90
to			
0/500			

NOTE:
 For shorter length ask our technical dept.
 For compound range, like -20 to 60°C, the stem length minimum is the same as 0/80 °C, by considering the total span.



Calle Pirita 12450 Galpón 22

La Chimba Alto Antofagasta - Fono (55) 261 8313

www.promid.cl

T500



BIMETAL THERMOMETERS

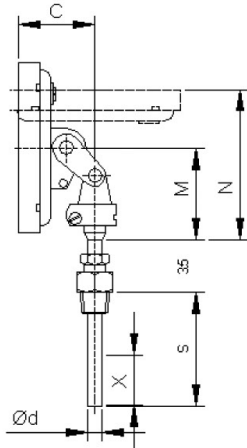

Every-angle

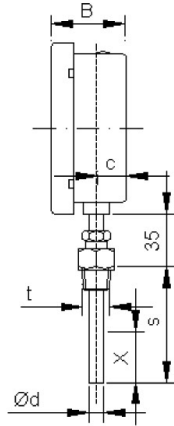

Lower connection

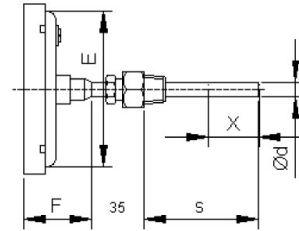

Back connection

Dimensions (mm)

DS	a	b	c	d	B	C	E	F	M	N	s
100	12,5	19	15,5	(1)	48	50,5	100	32	58	78	(2)
125	15	21	15,5	(1)	50	52,5	118,5	34	58	78	(2)
150	15	21	15,5	(1)	50	52,5	149	34	58	78	(2)

- (1) Available stem diameter : 6 – 6,4 – 8 – 10 - 12
 (2) Depending on scale range and bulb diameter

How to order

1) NOMINAL SIZE

100 125 150

2) BASIC MODEL

T500

3) THREAD CONNECTION (1)

7 1/2" NPT-M 8 1/2" BSP-M

(1) Other connections available on request

12 3/4" NPT-M 13 3/4" BSP-M

4) TYPE OF MOUNTING

L BOTTOM ENTRY

R CENTRAL BACK ENTRY

E EVERY ANGLE

5) SCALE RANGE

REFER TO TABLE

6) BULB SIZE

B6 BULB Ø 6 mm B64 BULB Ø 6,4 mm B8 BULB Ø 8 mm

B10 BULB Ø 10 mm B12 BULB Ø 12 mm

7) STEM LENGTH

S STEM LENGTH IN mm (INCLUDING THREAD)

8) OPTION

SF SAFETY GLASS P PLEXIGLASS WINDOW CS AISI 316 CASE AND RING

PG GLYCERINE FILLED DAMPENING LIQUID PZ SILICON OIL FILLED DAMPENING LIQUID

SJ MAXIMUM READING POINTER SX STAINLESS STEEL TAG PLATE SW DIAL TAG MARKING

RH CUSTOMER DESIGNED DIAL AT ATEX VERSION

EXAMPLE

1	2	3	4	5	6	7	8
125	T500	7	L	100 °C	B8	S 200	SF-SX



Calle Pirita 12450 Galpón 22
 La Chimba Alto Antofagasta - Fono (55) 261 8313

www.promid.cl